



Electrolux

# Modular Cooking Range Line 900XP One Well Gas Fryer 23 liter

ITEM # \_\_\_\_\_

MODEL # \_\_\_\_\_

NAME # \_\_\_\_\_

SIS # \_\_\_\_\_

AIA # \_\_\_\_\_



Electrolux



## Modular Cooking Range Line 900XP One Well Gas Fryer 23 liter

391079 (E9FRGD1JF0)

900XP ONE 23 LT WELL  
GAS FRYER - LPG/NATURAL  
GAS

### Short Form Specification

Item No. \_\_\_\_\_

High efficiency 20 kW burners in stainless steel. Suitable for natural gas or LPG. Deep drawn V-Shaped well. Oil drains through a tap into a container positioned under the well. Height adjustable feet in stainless steel. Exterior panels in stainless steel. Worktop in 20/10, stainless steel. Right-angled side edges eliminate gaps and possible dirt traps between units.

### Main Features

- Deep drawn V-Shaped well.
- Interior of well with rounded corners for ease of cleaning.
- High efficiency 20 kW burners in stainless steel with flame failure device attached to the outside of the well.
- Thermostatic regulation of oil temperature up to a maximum of 190 °C.
- Flame failure device to each burner.
- Overheat protection thermostat as standard on all units.
- Oil drains through a tap into a drainage container positioned under the well.
- All major compartments located in front of unit for ease of maintenance.
- Piezo spark ignition for added safety.
- IPX5 water resistance certification.
- The special design of the control knob system guarantees against water infiltration.
- Unit delivered with four 50 mm legs in stainless steel as standard (all round Stainless steel kick plates as option).
- Supplied as standard with 2 half size baskets and 1 right side door for cupboard.

### Construction

- Unit is 93 cm deep to give a larger working surface area.
- Exterior panels in Stainless Steel with Scotch Brite finish.
- Model has right-angled side edges to allow flush fitting joints between units, eliminating gaps and possible dirt traps.

### Included Accessories

- 1 of 2 half size baskets for 18/23lt well fryers PNC 927223

### Optional Accessories

- Junction sealing kit PNC 206086
- Draught diverter, 120 mm diameter PNC 206126
- Matching ring for flue condenser, 120 mm diameter PNC 206127
- Flanged feet kit PNC 206136
- Pressure regulator for gas units PNC 927225

APPROVAL: \_\_\_\_\_



Electrolux

# Modular Cooking Range Line 900XP One Well Gas Fryer 23 liter

Front

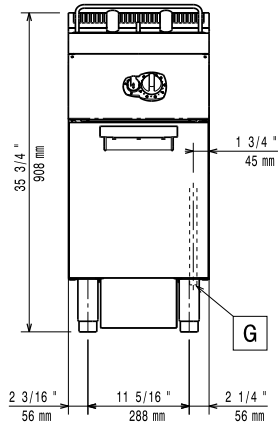

Top

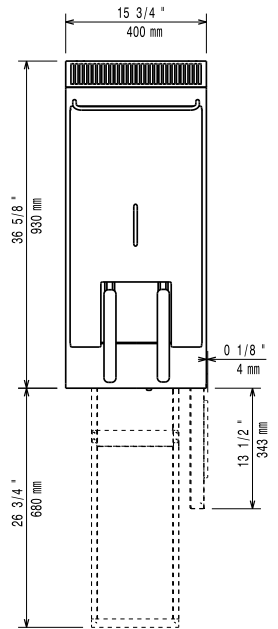

Side

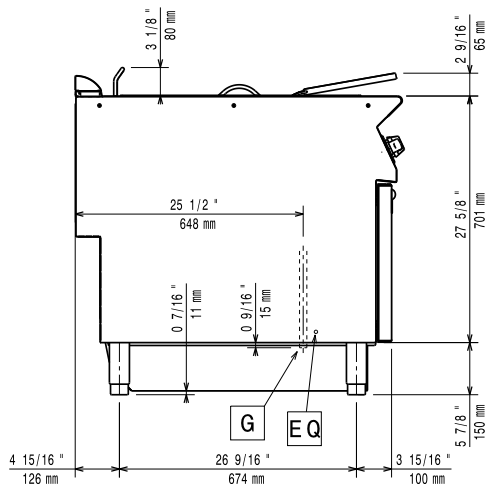

- DO = Overflow drain pipe
- G = Gas connection

## Gas

<b>Gas Power:</b>		68180 Btu/hr (20 kW)
<b>391079(E9FRGD1JF0)</b>		
<b>Gas Type Option:</b>		LPG; Natural Gas
<b>Gas Inlet:</b>		3/4" NPT
<b>Natural gas - Pressure:</b>		7" w.c. (17.4 mbar)
<b>LPG Gas Pressure:</b>		11" w.c. (27.7 mbar)

## Key Information:

<b>Usable well dimensions (width):</b>	340 mm
<b>Usable well dimensions (height):</b>	575 mm
<b>Usable well dimensions (depth):</b>	400 mm
<b>Well capacity:</b>	21 lt MIN; 23 lt MAX
<b>Thermostat Range:</b>	120 °C MIN; 190 °C MAX
<b>Net weight:</b>	57 kg
<b>Shipping weight:</b>	75 kg
<b>Shipping height:</b>	850 mm
<b>Shipping width:</b>	400 mm
<b>Shipping depth:</b>	930 mm
<b>Shipping volume:</b>	0.31 m <sup>3</sup>

If appliance is set up or next to or against temperature sensitive furniture or similar, a safety gap of approximately 150 mm should be maintained or some form of heat insulation fitted.



Modular Cooking Range Line  
900XP One Well Gas Fryer 23 liter

The company reserves the right to make modifications to the products without prior notice. All information correct at time of printing.