

GARLAND GFBRL SERIES

MODULAR HEAVY DUTY GAS CHAR BROILER

Range match Broilers available in four widths: 457mm, 610mm, 762mm, and 914mm. Designed to match GF sentry series ranges. Standard finish stainless steel front, sides, and backguard. Exclusive lift off stainless steel grease hopper. Dual sided cast iron broiler racks, 13mm rounded bar (broad) or diamond patterns (fine) on opposite sides in 152mm wide sections. Simple set Hi-Lo valves are located away from heat and protected. 16mJ cast iron burners for every 152mm of broiling width, natural or propane gas. Flame protection system with Piezo ignition.



STANDARD FEATURES

- Dual-sided cast iron broiler racks, 13mm rounded bar (broad) or diamond patterns (fine) on opposite sides
- Counter mount or range matched to Garland GF series ranges (when combined with optional stand or cabinet base)
- Stainless steel front, sides, front rail, hopper and side splash guards.
- Removable broiling grates 584mm deep in 152mm wide sections.
- 102mm sanitary legs for counter mount installations
- 16mJ cast iron burners for every 152mm of broiler space.
- Exclusive lift off hopper top
- Heavy duty ceramic briquettes
- Flame failure protection Hi-Lo valves
- Piezo Spark Pilot Ignition
- 3/4" N.P.T. rear gas connection
- Stainless steel low profile backguard

GF18-BRL

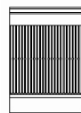

GF24-BRL

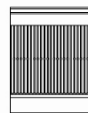

GF30-BRL

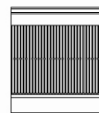

GF36-BRL

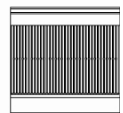

OPTIONAL FEATURES

- Stand with castors: MS18B, MS24B, MS30B, MS36B

SPECIFICATIONS ARE SUBJECT TO CHANGE WITHOUT NOTICE.

From the world of Comcater!

National Head Office
156 Swann Drive
Derrimut VIC 3030
Tel: +61 3 8369 4600
Fax: +61 3 8369 4695

Melbourne
96-100 Tope Street,
South Melbourne VIC 3205
Tel: +61 3 8369 4600
Fax: +61 2 8699 1299

Sydney
20/4 Avenue of the Americas
Newington, NSW 2127
Tel: +61 2 9748 3000
Fax: +61 2 9 648 4762

Brisbane
1/62 Borthwick Avenue
Murarrie QLD 4172
Tel: +61 7 3399 3122
Fax: +61 7 3399 5311

GARLAND GFBRL SERIES

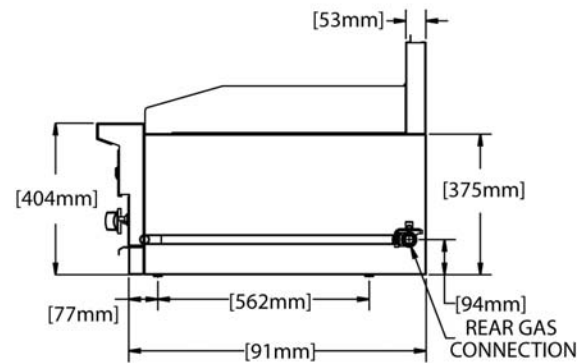
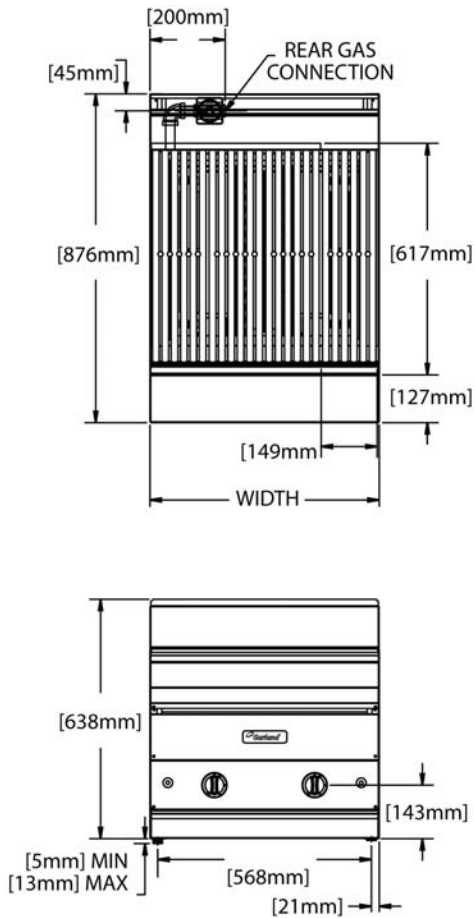

DIMENSIONS

External Dimension:

457W x 876D x 638H mm (GF18-BRL)

610W x 876D x 638H mm (GF24-BRL)

762W x 876D x 638H mm (GF30-BRL)

914W x 876D x 638H mm (GF36-BRL)

TECHNICAL DATA

Gas Type	Natural
Total Energy Rating	47mj (GF18-BRL) 63mj (GF24-BRL) 79mj (GF30-BRL) 95mj (GF36-BRL)

AGA Approval Number 7497

SPECIFICATIONS ARE SUBJECT TO CHANGE WITHOUT NOTICE.